

v1.1

www.FulcrumNorthDavis.com



FULCRUM NORTH DAVIS
a new **Medical Office Building**

FOR MORE LEASING INFO
PLEASE CONTACT THE DEVELOPMENT TEAM @
INFO@FulcrumNorthDavis.com or
Rick Lochead, 850-816-0720

The information provided here has been secured by Fulcrum North Davis, LLC from sources believed to be reliable. All information, plans, and design provided here are subject to change (per local approvals, tenant requirements, schedule, material costs, budget, etc.) and are not guaranteed. All should be verified prior to consummating any transaction.

8354 n davis hwy, pensacola, fl 32514



FULCRUM NORTH DAVIS

lease opportunities

**SUITES DELIVERED
Q4 2021**

**SUITES AVAILABLE IN
“TURN-KEY”, “SHELL”,
OR “VANILLA-BOX”
CONDITION.
WE WILL CUSTOMIZE
YOUR SUITE TO YOUR
SPECIFIC NEEDS.**

**TERM, RATES, AND
TENANT ALLOWANCE
OPTIONS NEGOTIABLE.**



4-13

market maps

aerials and maps showing adjacent businesses, roads, and traffic counts.



14-15

site lease plan

site lease plan showing proposed development site plan including space available & leased.



16-27

suite detail

breakdown of available suites.

FOR MORE LEASING INFO
PLEASE CONTACT THE DEVELOPMENT TEAM @
INFO@FulcrumNorthDavis.com or
Rick Lochead, 850-816-0720

The information provided here has been secured by Fulcrum North Davis, LLC from sources believed to be reliable. All information, plans, and design provided here are subject to change (per local approvals, tenant requirements, schedule, material costs, budget, etc.) and are not guaranteed. All should be verified prior to consummating any transaction.

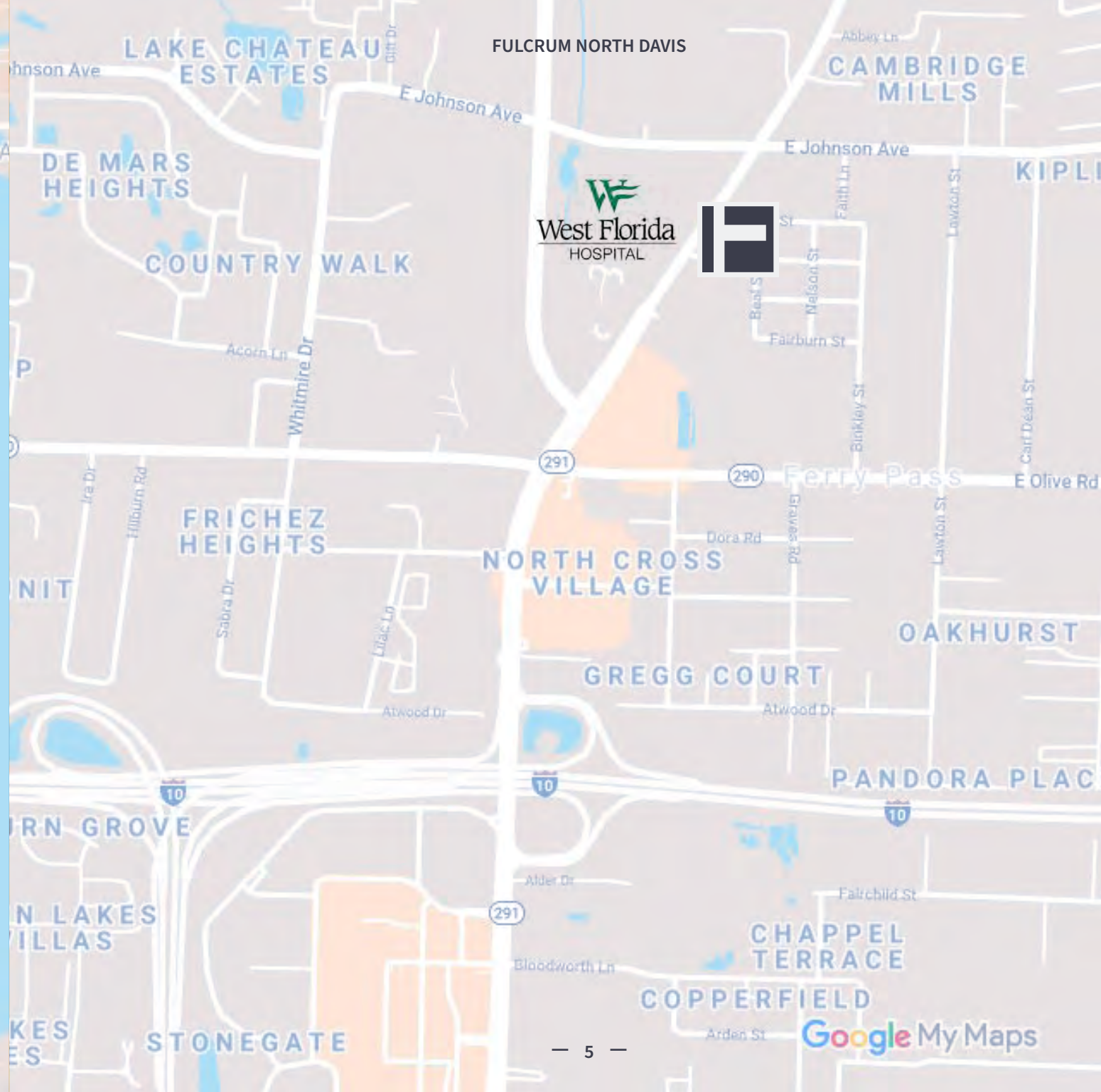
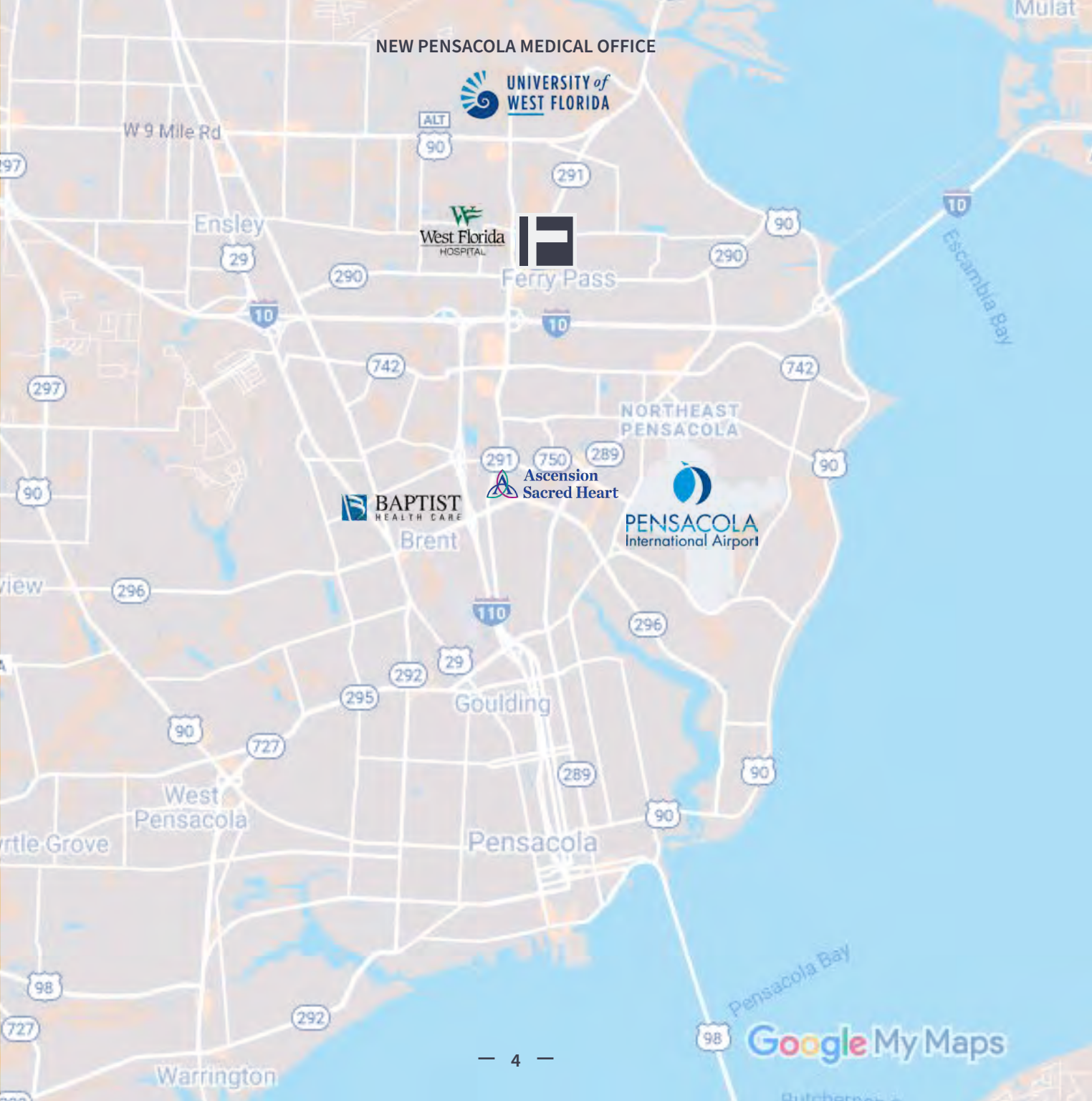

NEW PENSACOLA MEDICAL OFFICE



FULCRUM NORTH DAVIS

E. JOHNSON AVE. - 5,100 AADT



N. DAVIS HWY. - 32,500 AADT



8354 n davis hwy
pensacola, fl 32514



UNIVERSITY PKWY. - 24,500 AADT



N. DAVIS HWY. - 71,000 AADT

The information provided here has been secured by Fulcrum North Davis, LLC from sources believed to be reliable. All information, plans, and design provided here are subject to change (per local approvals, tenant requirements, schedule, material costs, budget, etc.) and are not guaranteed. All should be verified prior to consummating any transaction.







FOR MORE LEASING INFO
 PLEASE CONTACT THE DEVELOPMENT TEAM @
 INFO@FulcrumNorthDavis.com or
 Rick Lochead, 850-816-0720

The information provided here has been secured by Fulcrum North Davis, LLC from sources believed to be reliable. All information, plans, and design provided here are subject to change (per local approvals, tenant requirements, schedule, material costs, budget, etc.) and are not guaranteed. All should be verified prior to consummating any transaction.

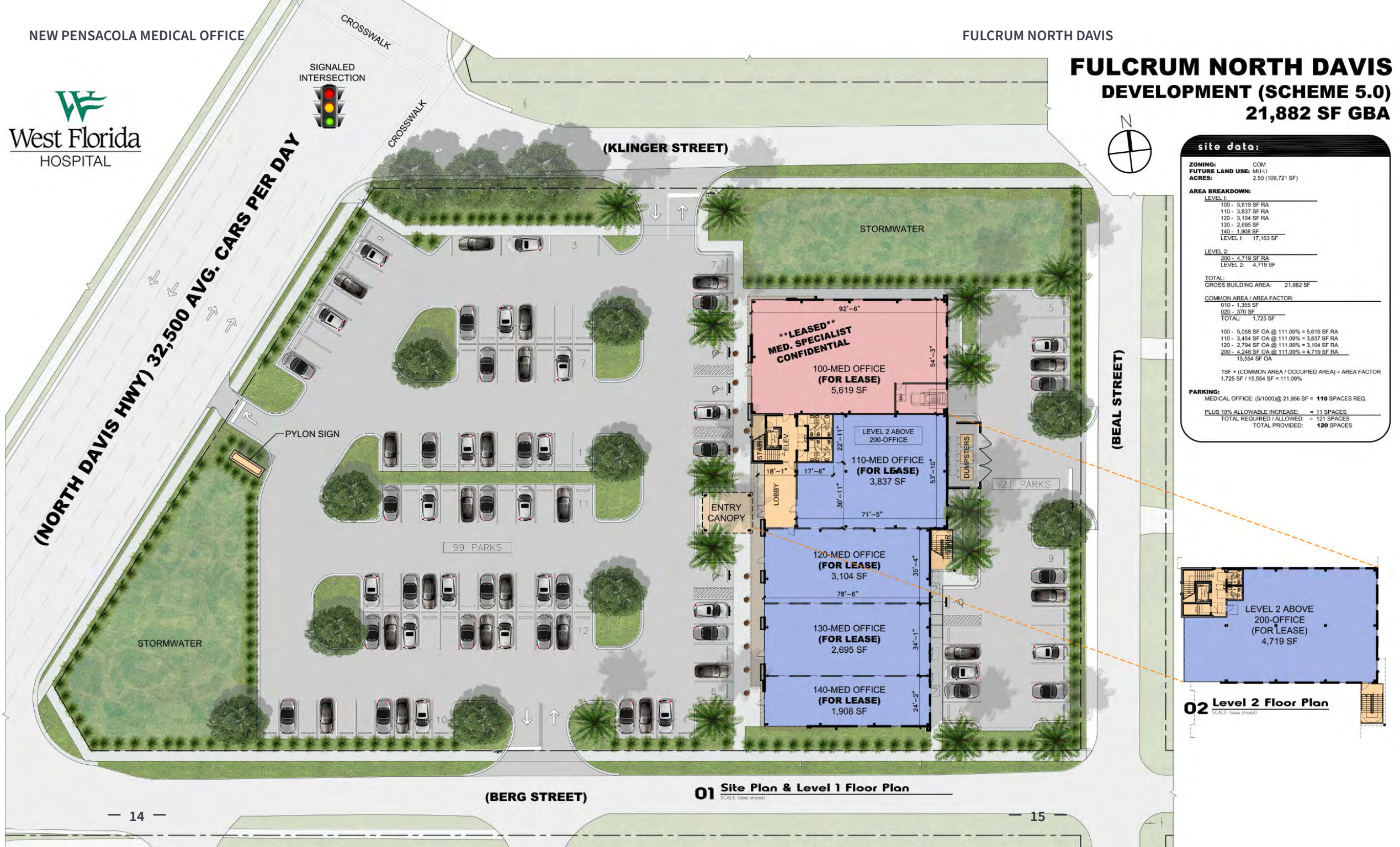

Suite 100



SUITE DELIVERED
Q4 2021

****LEASED****

TO CONFIDENTIAL MED. SPECIALIST
LANDLORD IS PROVIDING A COMPLETE "TURN-KEY"
MEDICAL OFFICE. OUR TEAM COORDINATED WITH
DOCTOR AND STAFF TO CUSTOMIZE A MEDICAL OFFICE
SUITE SPECIFIC TO THE TENANTS NEEDS.

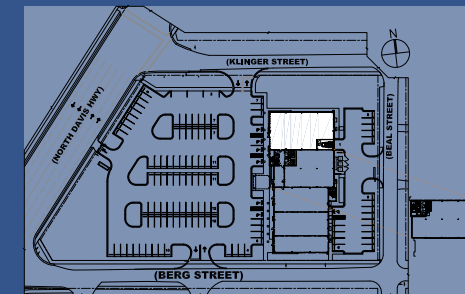

Suite 100

SUITE 100 - 5,619 SF

- access from common lobby
- use and access to common restrooms
- suite size may be adjusted
- great facade signage opportunity
- pylon sign panel available

FOR MORE LEASING INFO

PLEASE CONTACT THE DEVELOPMENT TEAM @
INFO@FulcrumNorthDavis.com or
Rick Lochead, 850-816-0720

The information provided here has been secured by Fulcrum North Davis, LLC from sources believed to be reliable. All information, plans, and design provided here are subject to change (per local approvals, tenant requirements, schedule, material costs, budget, etc.) and are not guaranteed. All should be verified prior to consummating any transaction.



Suite 110



SUITE DELIVERED Q4 2021

SUITES ARE AVAILABLE "TURN-KEY". OUR TEAM WILL COORDINATE WITH YOU TO CUSTOMIZE YOUR SUITE TO YOUR SPECIFIC REQUIREMENTS.

SUITES ALSO AVAILABLE IN "SHELL" OR "VANILLA-BOX" CONDITION. TERM, RATES, AND TENANT ALLOWANCE OPTIONS NEGOTIABLE.

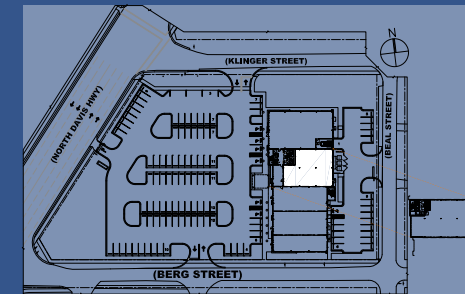

Suite 110

SUITE 110 - 3,837 SF

- access from common lobby
- use and access to common restrooms
- suite size may be adjusted
- great facade signage opportunity
- pylon sign panel available

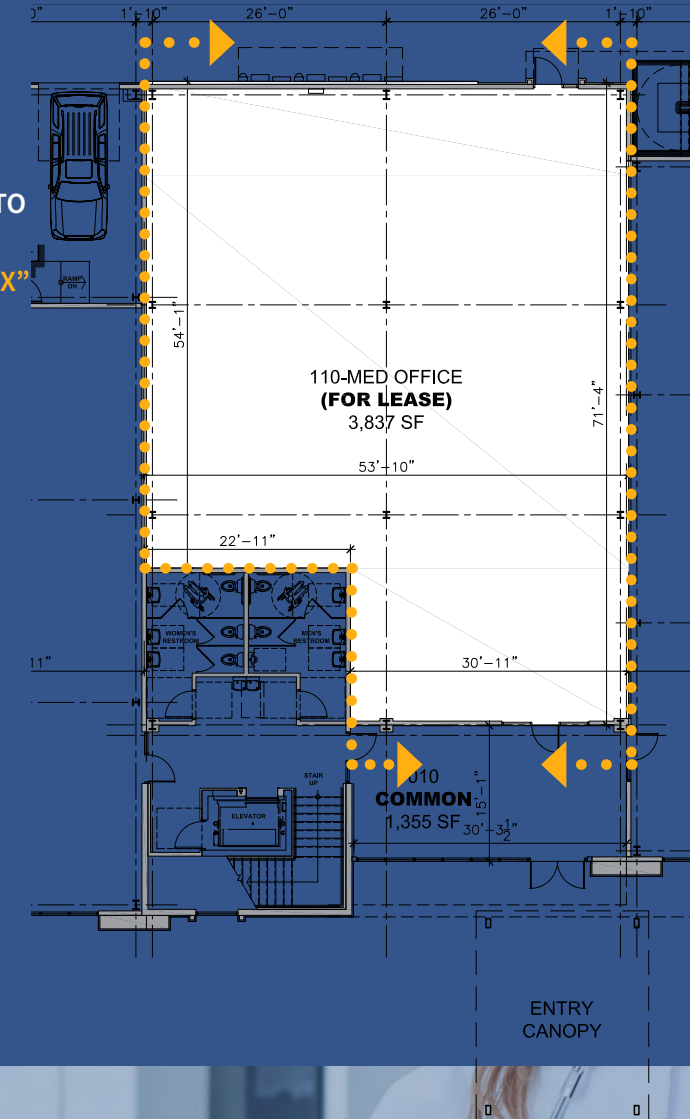

FOR MORE LEASING INFO

PLEASE CONTACT THE DEVELOPMENT TEAM @ INFO@FulcrumNorthDavis.com or Rick Lochead, 850-816-0720

The information provided here has been secured by Fulcrum North Davis, LLC from sources believed to be reliable. All information, plans, and design provided here are subject to change (per local approvals, tenant requirements, schedule, material costs, budget, etc.) and are not guaranteed. All should be verified prior to consummating any transaction.

Suite 120



SUITE DELIVERED Q4 2021

SUITES ARE AVAILABLE “TURN-KEY”. OUR TEAM WILL COORDINATE WITH YOU TO CUSTOMIZE YOUR SUITE TO YOUR SPECIFIC REQUIREMENTS.

SUITES ALSO AVAILABLE IN “SHELL” OR “VANILLA-BOX” CONDITION. TERM, RATES, AND TENANT ALLOWANCE OPTIONS NEGOTIABLE.

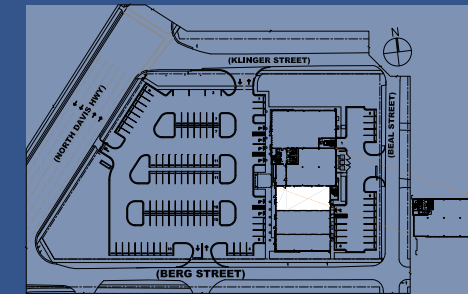

Suite 120

SUITE 120 - 3,104 SF

- access from common lobby
- use and access to common restrooms
- suite size may be adjusted
- great facade signage opportunity
- pylon sign panel available

FOR MORE LEASING INFO

PLEASE CONTACT THE DEVELOPMENT TEAM @ INFO@FulcrumNorthDavis.com or Rick Lochead, 850-816-0720

The information provided here has been secured by Fulcrum North Davis, LLC from sources believed to be reliable. All information, plans, and design provided here are subject to change (per local approvals, tenant requirements, schedule, material costs, budget, etc.) and are not guaranteed. All should be verified prior to consummating any transaction.

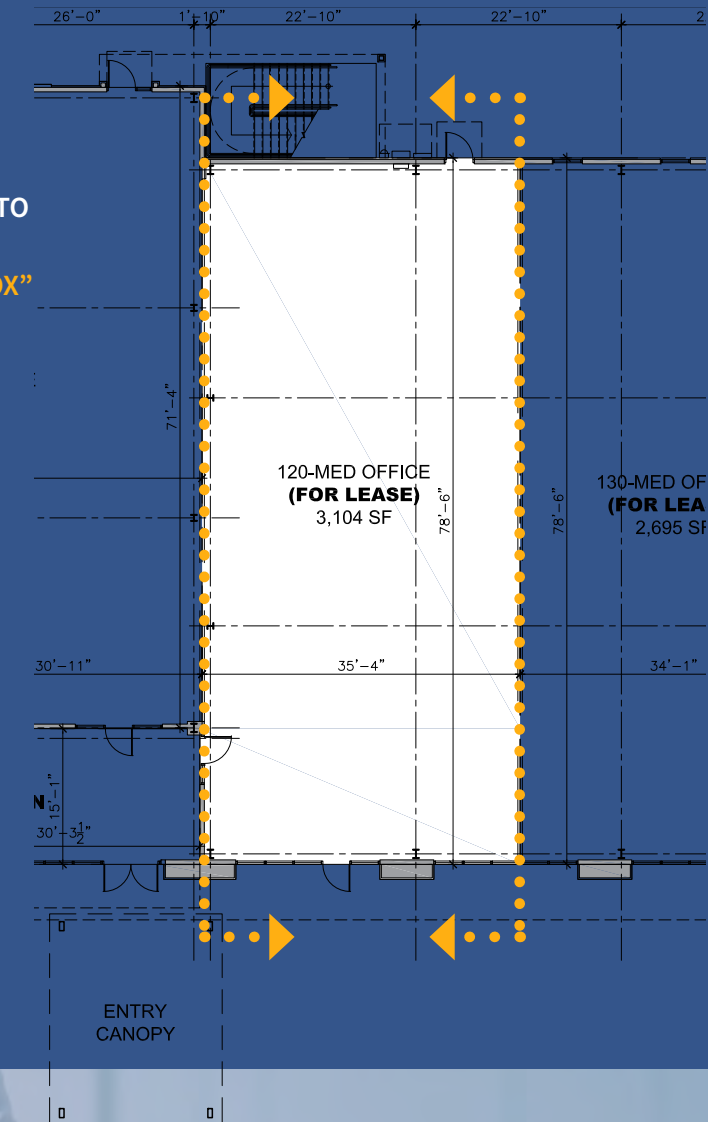

Suite 130



SUITE DELIVERED Q4 2021

SUITES ARE AVAILABLE "TURN-KEY". OUR TEAM WILL COORDINATE WITH YOU TO CUSTOMIZE YOUR SUITE TO YOUR SPECIFIC REQUIREMENTS.

SUITES ALSO AVAILABLE IN "SHELL" OR "VANILLA-BOX" CONDITION. TERM, RATES, AND TENANT ALLOWANCE OPTIONS NEGOTIABLE.

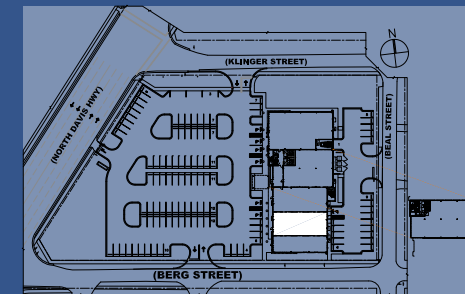

Suite 130

SUITE 130 - 2,695 SF

- suite size may be adjusted
- great facade signage opportunity
- pylon sign panel available

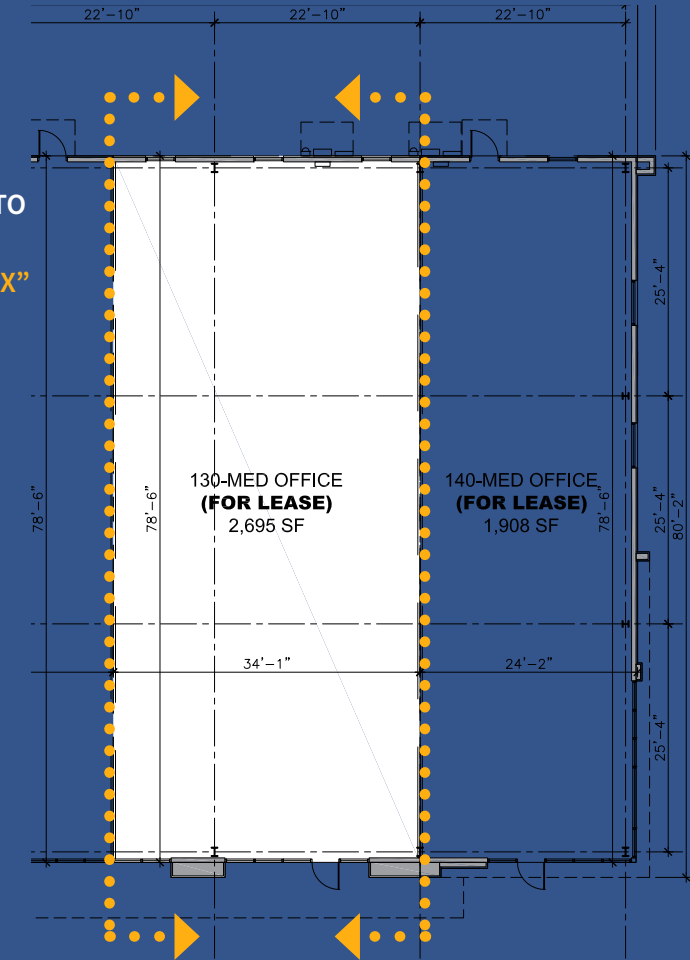

FOR MORE LEASING INFO

PLEASE CONTACT THE DEVELOPMENT TEAM @ INFO@FulcrumNorthDavis.com or Rick Lochead, 850-816-0720

The information provided here has been secured by Fulcrum North Davis, LLC from sources believed to be reliable. All information, plans, and design provided here are subject to change (per local approvals, tenant requirements, schedule, material costs, budget, etc.) and are not guaranteed. All should be verified prior to consummating any transaction.

NEW PENSACOLA MEDICAL OFFICE

Suite 140



FULCRUM NORTH DAVIS

SUITE DELIVERED Q4 2021

SUITES ARE AVAILABLE "TURN-KEY". OUR TEAM WILL COORDINATE WITH YOU TO CUSTOMIZE YOUR SUITE TO YOUR SPECIFIC REQUIREMENTS.

SUITES ALSO AVAILABLE IN "SHELL" OR "VANILLA-BOX" CONDITION. TERM, RATES, AND TENANT ALLOWANCE OPTIONS NEGOTIABLE.

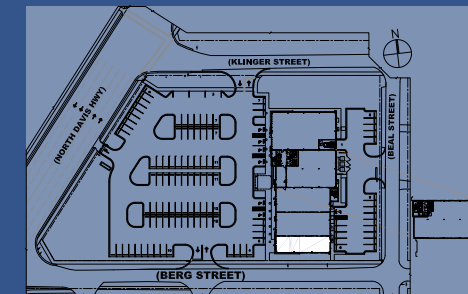

Suite 140

SUITE 140 - 1,908 SF

- suite size may be adjusted
- great facade signage opportunity
- pylon sign panel available

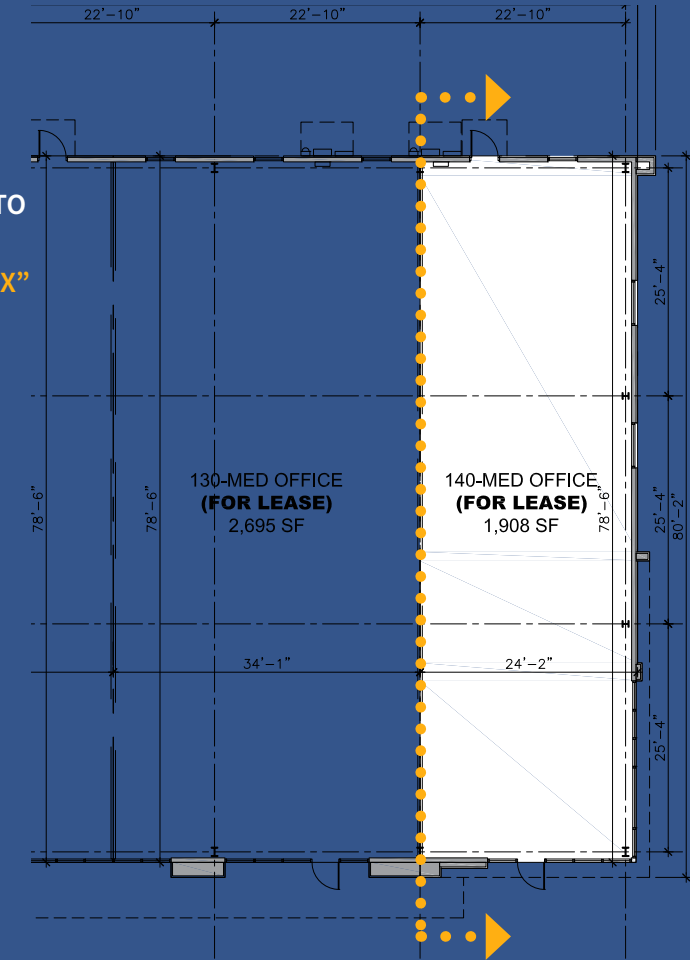

FOR MORE LEASING INFO

PLEASE CONTACT THE DEVELOPMENT TEAM @ INFO@FulcrumNorthDavis.com or Rick Lochead, 850-816-0720

The information provided here has been secured by Fulcrum North Davis, LLC from sources believed to be reliable. All information, plans, and design provided here are subject to change (per local approvals, tenant requirements, schedule, material costs, budget, etc.) and are not guaranteed. All should be verified prior to consummating any transaction.



FULCRUM NORTH DAVIS

SUITE DELIVERED
Q4 2021

SUITES ARE AVAILABLE "TURN-KEY". OUR TEAM WILL COORDINATE WITH YOU TO CUSTOMIZE YOUR SUITE TO YOUR SPECIFIC REQUIREMENTS.

SUITES ALSO AVAILABLE IN "SHELL" OR "VANILLA-BOX" CONDITION. TERM, RATES, AND TENANT ALLOWANCE OPTIONS NEGOTIABLE.

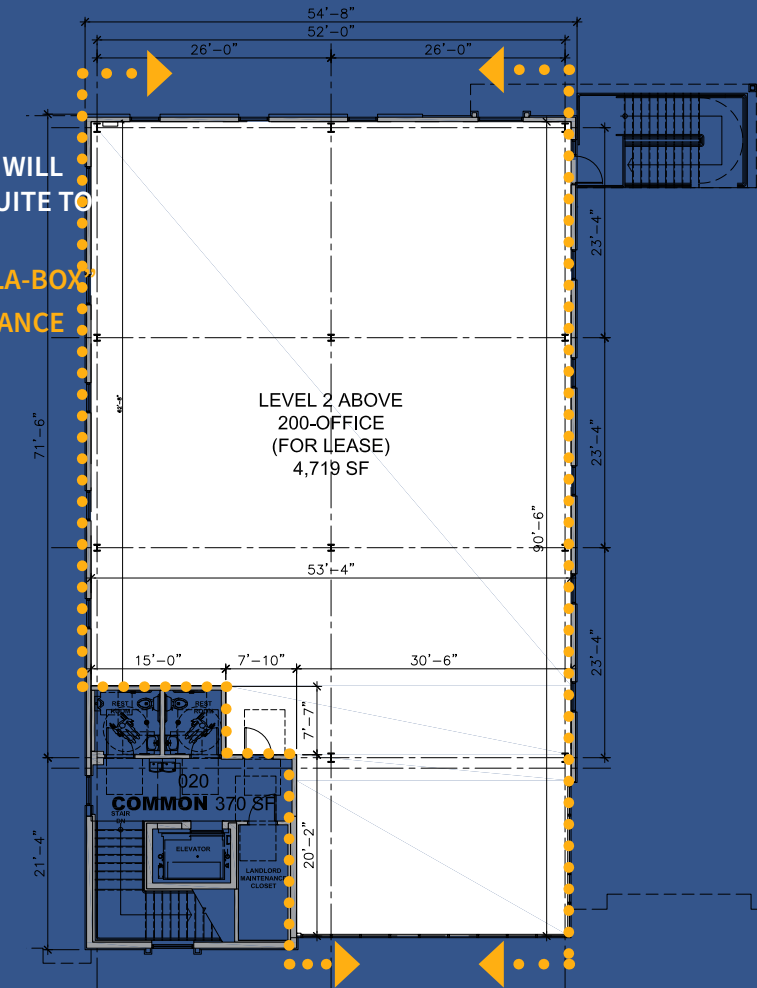
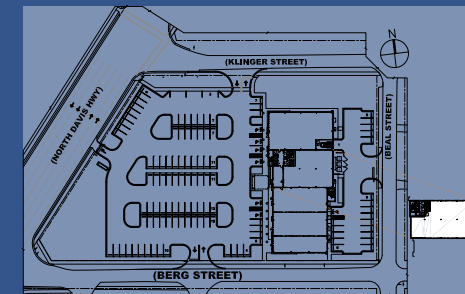

Suite 200

SUITE 200 - 4,719 SF

- access from common lobby
- use and access to common restrooms
- suite size may be adjusted
- great facade signage opportunity
- pylon sign panel available

FOR MORE LEASING INFO

PLEASE CONTACT THE DEVELOPMENT TEAM @
INFO@FulcrumNorthDavis.com or
Rick Lochead, 850-816-0720

The information provided here has been secured by Fulcrum North Davis, LLC from sources believed to be reliable. All information, plans, and design provided here are subject to change (per local approvals, tenant requirements, schedule, material costs, budget, etc.) and are not guaranteed. All should be verified prior to consummating any transaction.

